

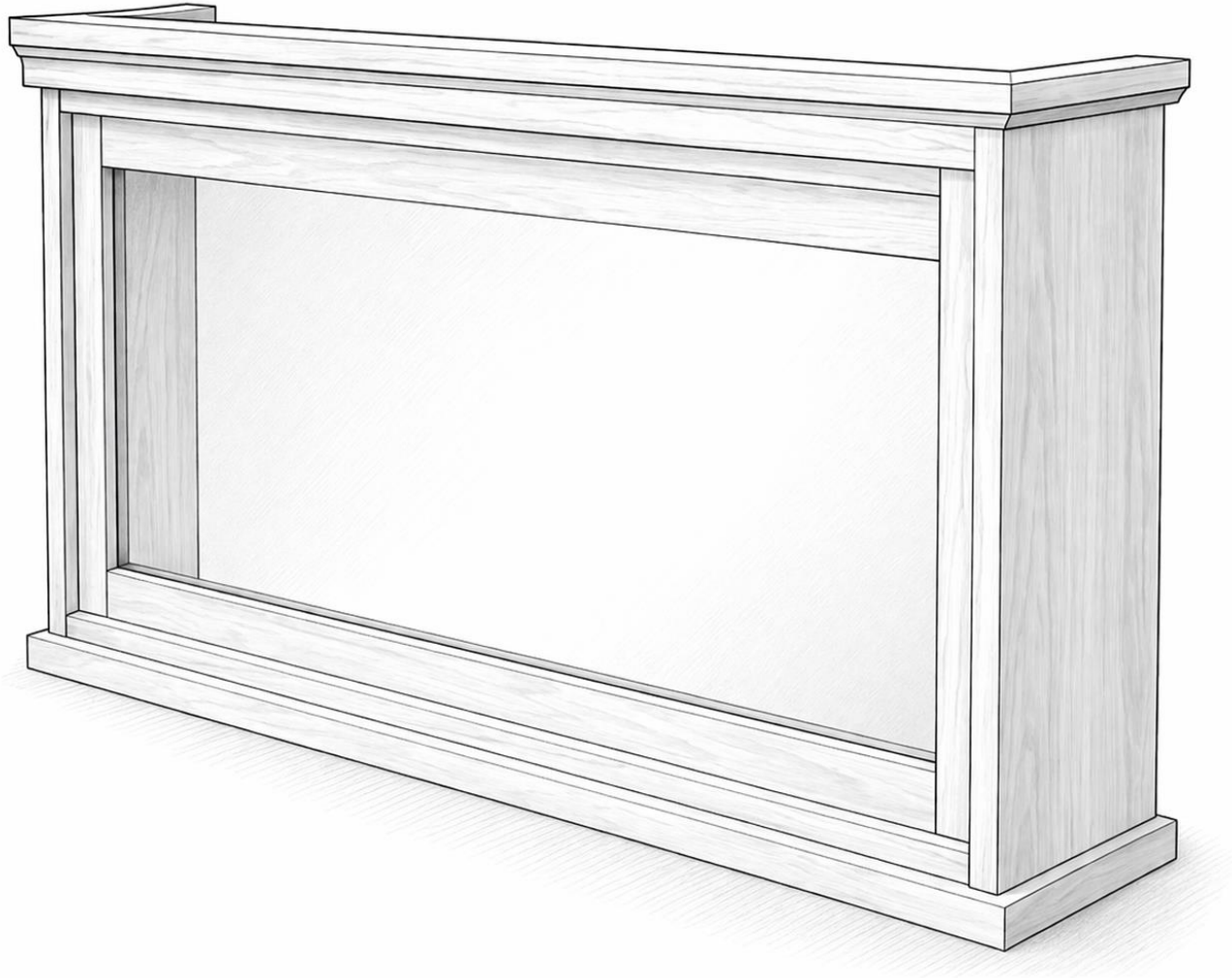

# Belle Starr

Installation instructions





# Belle Starr

The cabinet is installed with a French cleat system.

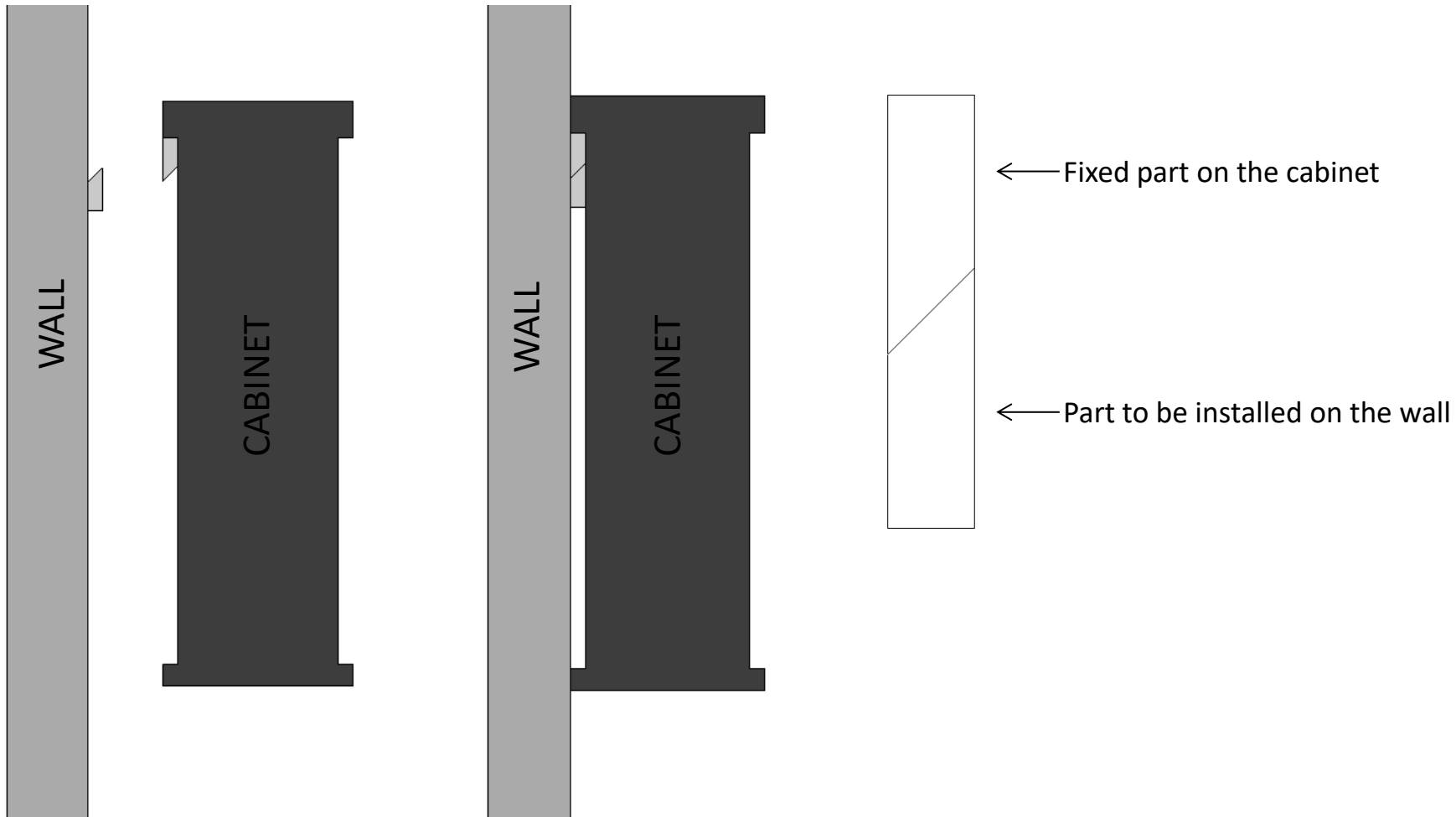



# Belle Starr

**Step 1** :determine at what height you want to install the furniture based on the following details:

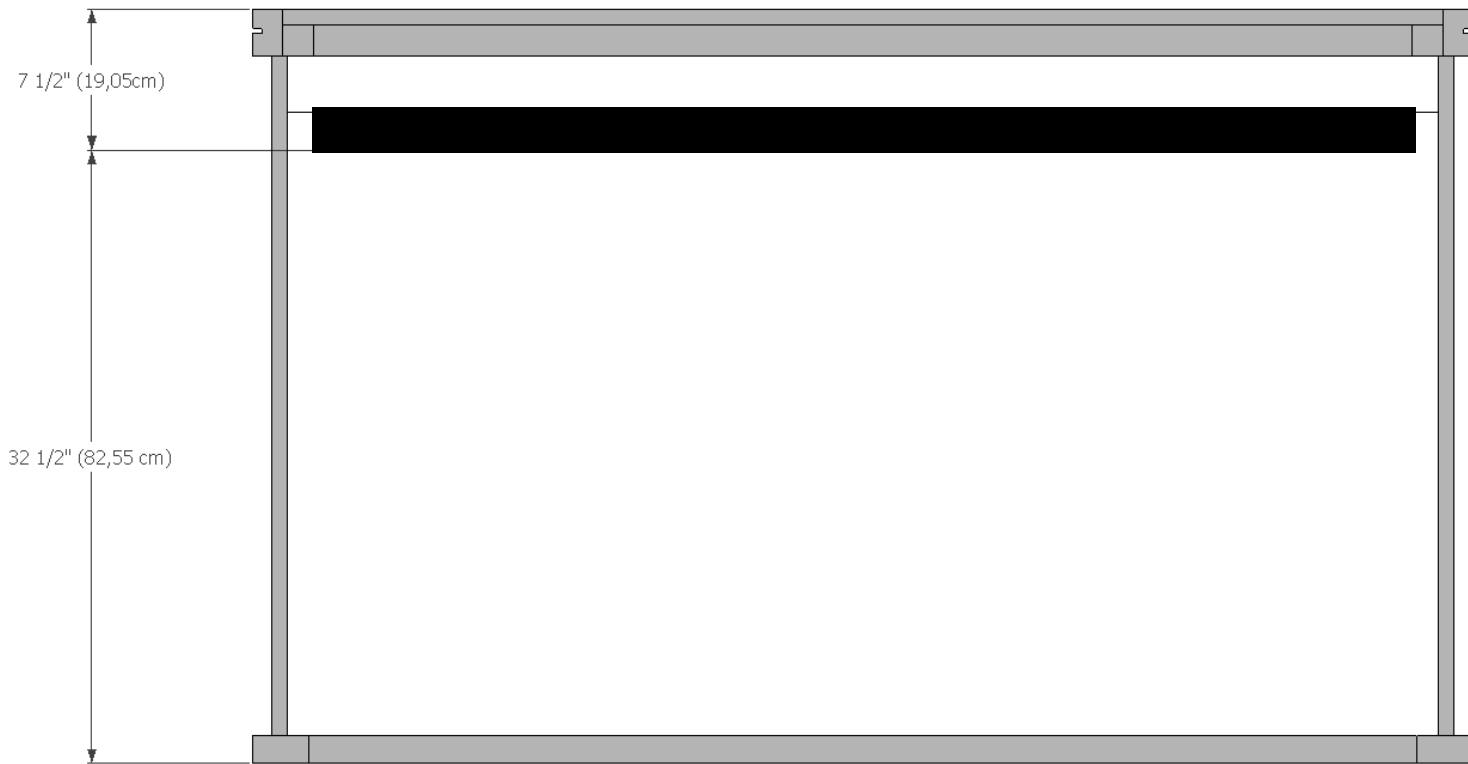

**Examples:** To have the top of the furniture at 80" (203.2 cm) from the floor, you must install the bottom of the cleat at 72 1/2" (184.15 cm). If you prefer to have the bottom of the furniture at 30" from the floor, you must install the bottom of the cleat at 62 1/2" (157.75 cm)



# Belle Starr

**Step 2** : locate the studs in the wall and mark them.

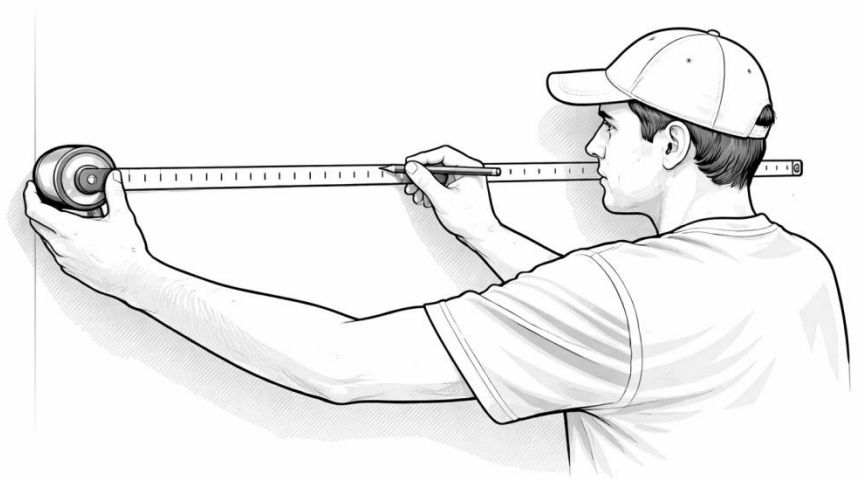



# Belle Starr

**Step 3** : level the French cleat and make sure you place the lower edge of the angle against the wall.

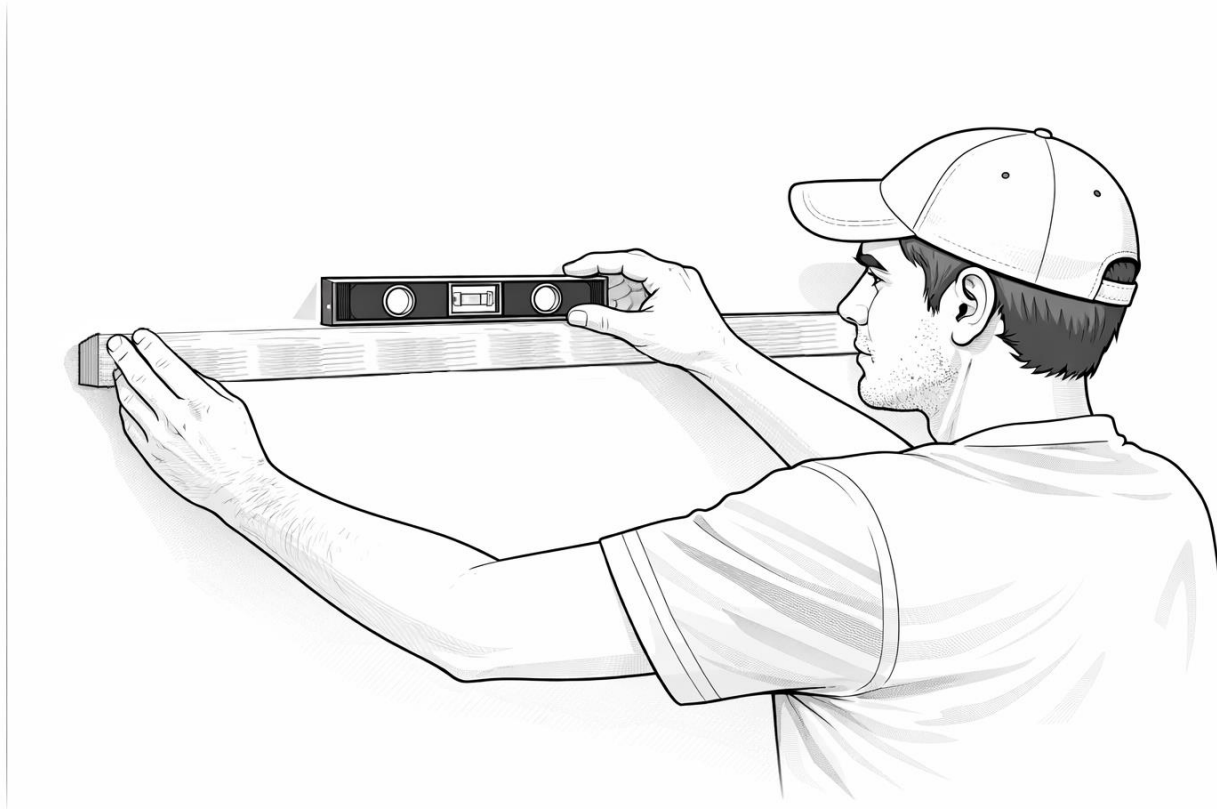



# Belle Starr

**Step 4** : pre-drill and countersink holes aligned with the stud marks.  
(One or ideally two per stud; see next page for positioning)

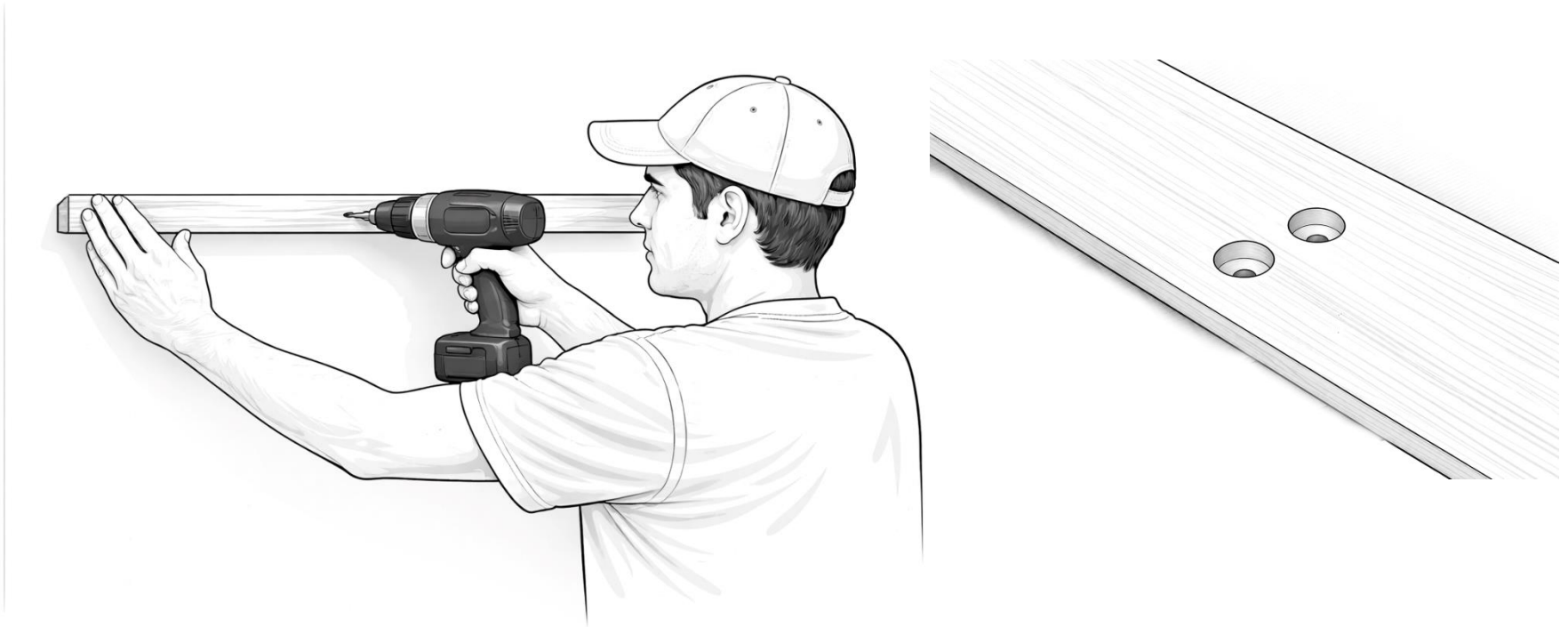

(Bits included: 3/16" for drilling and 3/8" for countersinking)



# Belle Starr

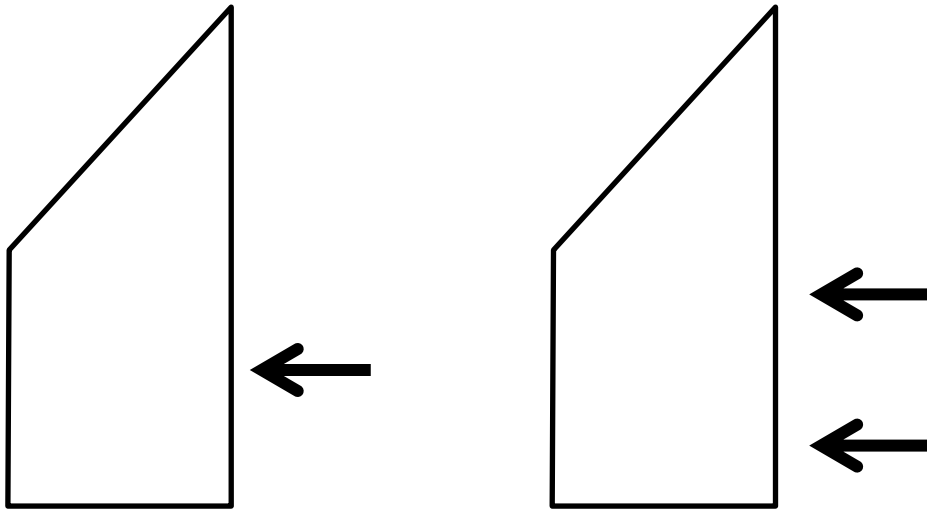

Do not screw into the angle.

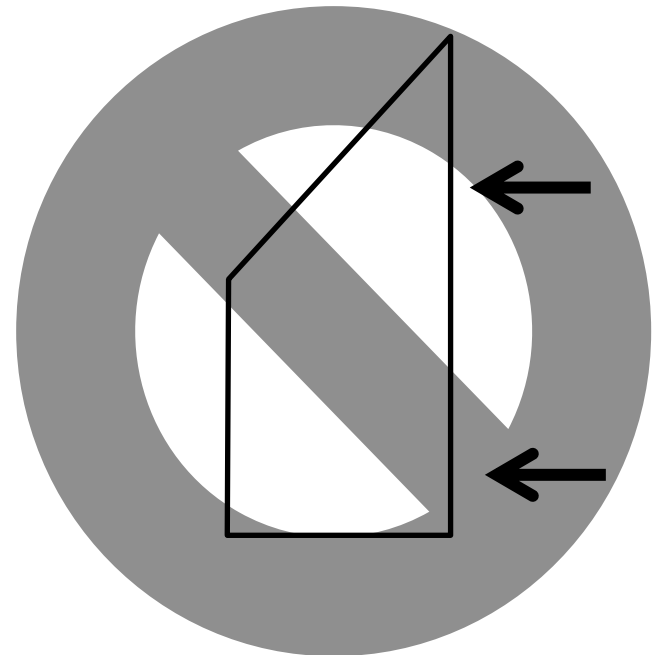



# Belle Starr

**Step 5** : drive screws into the studs using #12 × 3 ½" long screws through the holes.  
(Screws included)

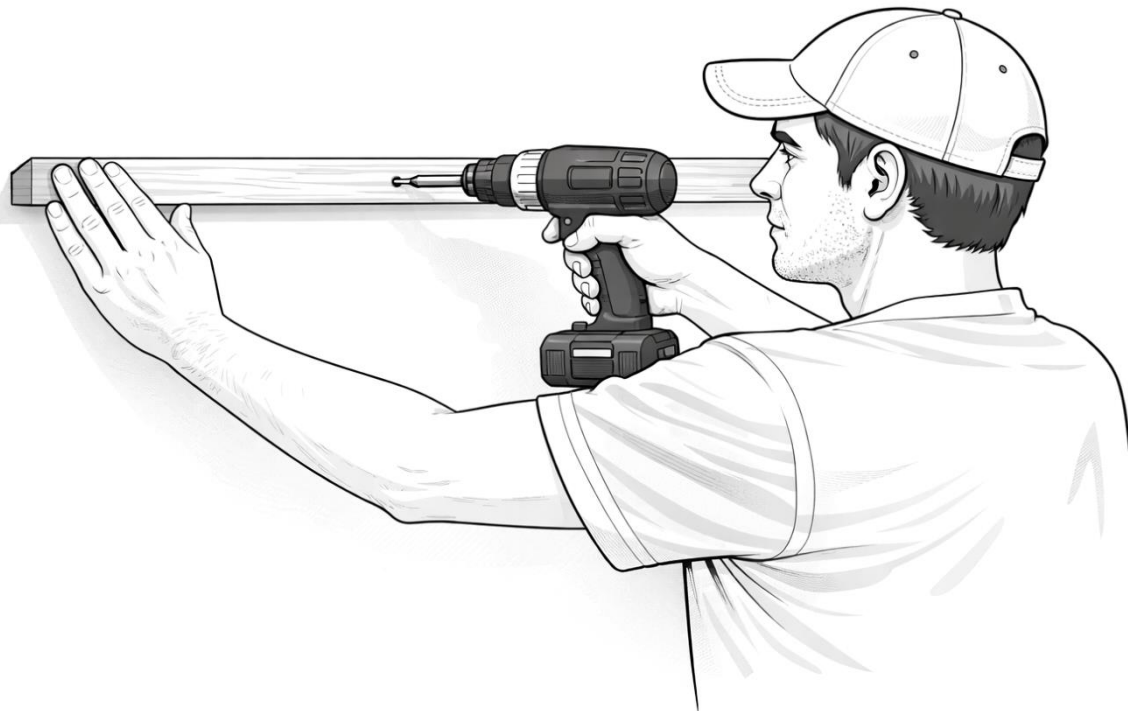



# Belle Starr

**Step 6** : hang the cabinet onto the French cleat.

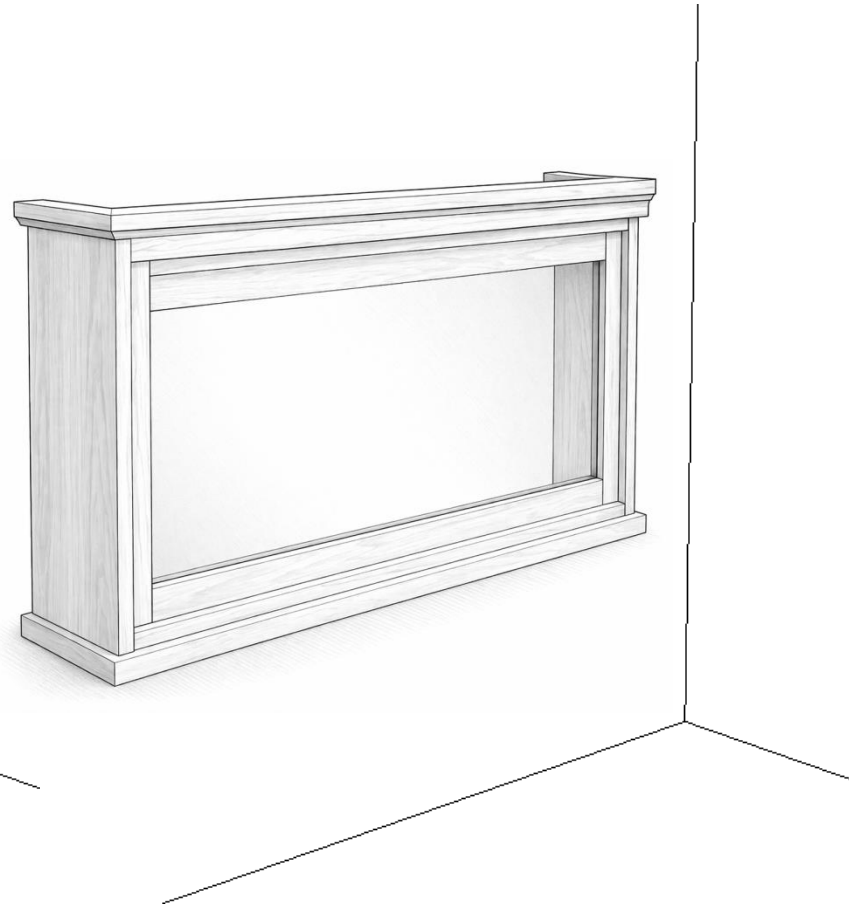
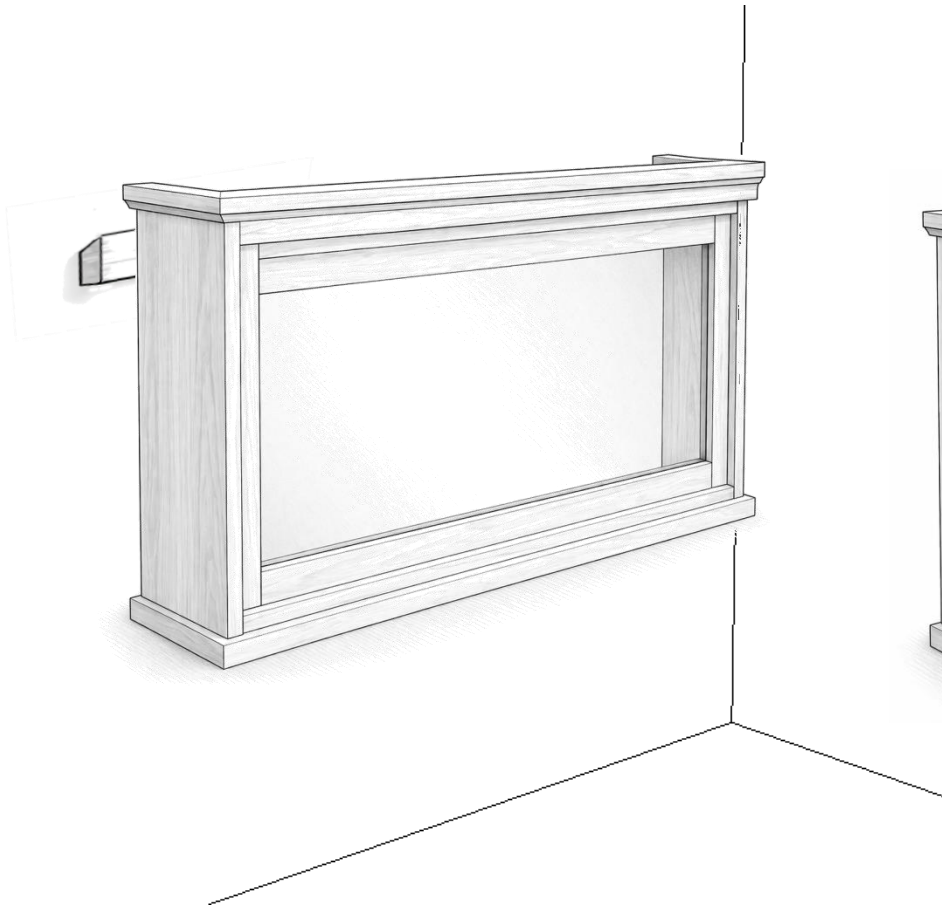



# Belle Starr

**Step 7** : secure the furniture to the wall by driving screws at the bottom on both sides.  
(Screws included)

